

# SEVENTH ADMINISTRATIVE JUDICIAL REGION

HONORABLE DEAN RUCKER  
 PRESIDING JUDGE  
 200 W. WALL, SUITE 200  
 MIDLAND, TEXAS 79701  
 (432) 688-4390

## COUNTIES INCLUDED IN THE SEVENTH ADMINISTRATIVE JUDICIAL REGION AND JUDICIAL DISTRICTS IN EACH COUNTY

<b>ANDREWS</b> 109	<b>DAWSON</b> 106	<b>IRION</b> 51	<b>MIDLAND</b> See Table Below	<b>SHACKELFORD</b> 259
<b>BORDEN</b> 132	<b>ECTOR</b> 70, 161, 244, 358	<b>JONES</b> 259	<b>MILLS</b> 35	<b>STERLING</b> 51
<b>BROWN</b> 35	<b>FISHER</b> 32	<b>KENT</b> 39	<b>MITCHELL</b> 32	<b>STONEWALL</b> 39
<b>CALLAHAN</b> 42	<b>GAINES</b> 106	<b>LOVING</b> 143	<b>NOLAN</b> 32	<b>TAYLOR</b> 42, 104, 326, 350
<b>COKE</b> 51	<b>GARZA</b> 106	<b>LYNN</b> 106	<b>REEVES</b> 143	<b>THROCKMORTON</b> 39
<b>COLEMAN</b> 42	<b>GLASSCOCK</b> 118	<b>McCULLOCH</b> 198	<b>RUNNELS</b> 119	<b>TOM GREEN</b> 51, 119, 340, 391
<b>CONCHO</b> 119	<b>HASKELL</b> 39	<b>MARTIN</b> 118	<b>SCHLEICHER</b> 51	<b>WARD</b> 143
<b>CRANE</b> 109	<b>HOWARD</b> 118	<b>MENARD</b> 198	<b>SCURRY</b> 132	<b>WINKLER</b> 109

COUNTIES WITH OVERLAPPING JUDICIAL DISTRICTS			COUNTIES WITH SINGLE OR COTERMINOUS JUDICIAL DISTRICTS		
MAP SYMBOL	JUDICIAL DISTRICT	COUNTIES INCLUDED	MAP SYMBOL	JUDICIAL DISTRICT	COUNTIES INCLUDED
☐	42	Callahan Coleman Taylor	▬	32	Fisher Mitchell Nolan
■	51	Coke Irion Schleicher Sterling Tom Green	▬	35	Brown Mills
△	104 326 350	Taylor	▬	39	Haskell Kent Stonewall Throckmorton
☆	119	Concho Runnels Tom Green	▬	70	Ector
●	198	<i>Edwards</i> <i>Kerr</i> <i>Kimble</i> <i>Mason</i> McCulloch Menard	▬	161 244 358	
▲	340 391	Tom Green	▬	106	Dawson Gaines Garza Lynn
			⊙	109	Andrews Crane Winkler
			▬	118	Glasscock Howard Martin
			▬	132	Borden Scurry
			▬	142 238 318 385 441	Midland
			▬	143	Loving Reeves Ward
			▬	259	Jones Shackelford

Counties in italics are not in this Administrative Judicial Region. See footnote on succeeding

# SEVENTH ADMINISTRATIVE JUDICIAL REGION

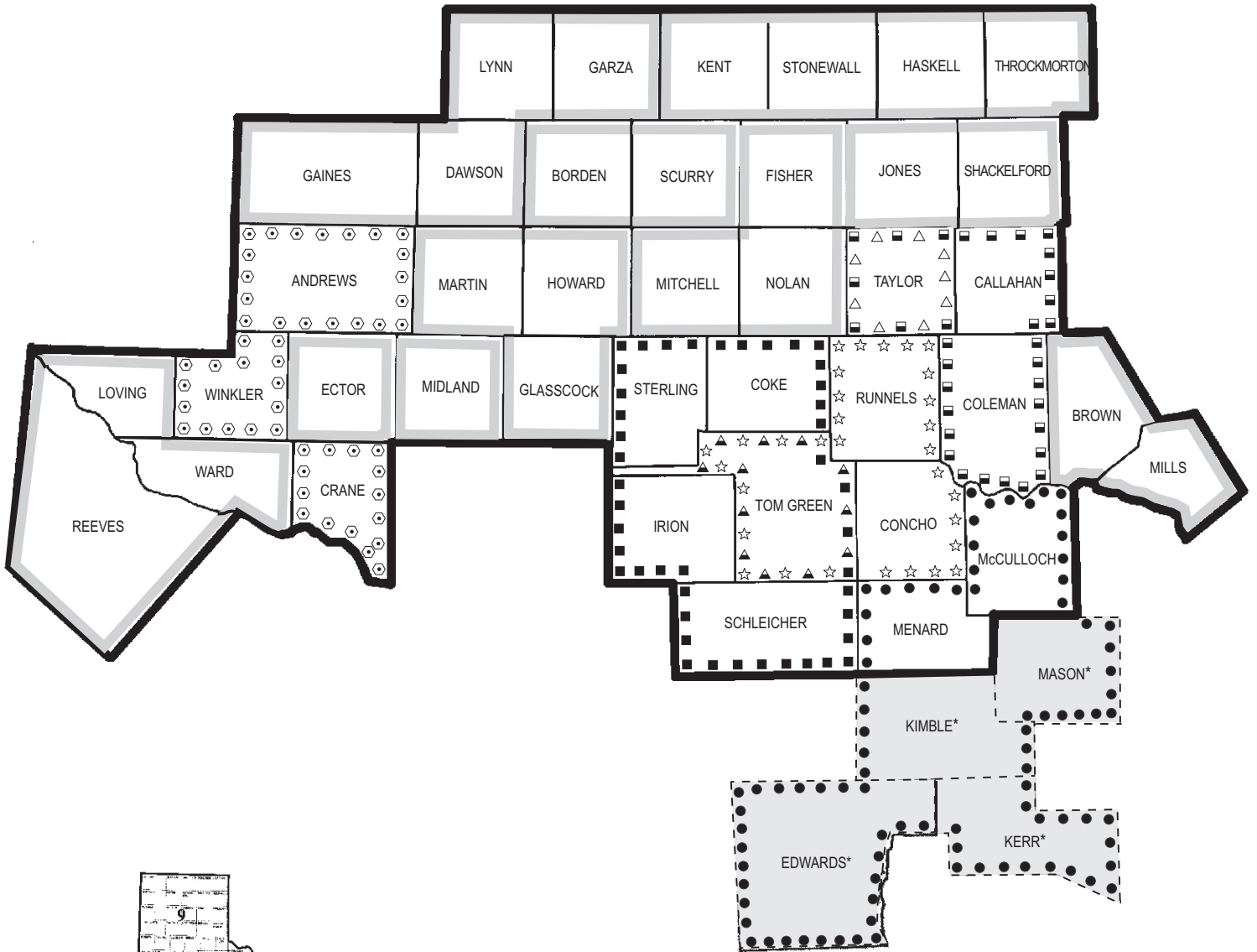

\* Edwards, Kerr, Kimble, and Mason counties are in the 6th Administrative Judicial Region and share the 198th District Court with McCulloch and Menard counties, which are in the 7th Administrative Judicial Region.